

STOURTON WALL MOUNTED TOWEL WARMER
3 Rail, 550 x 550 x 145mm

9-200

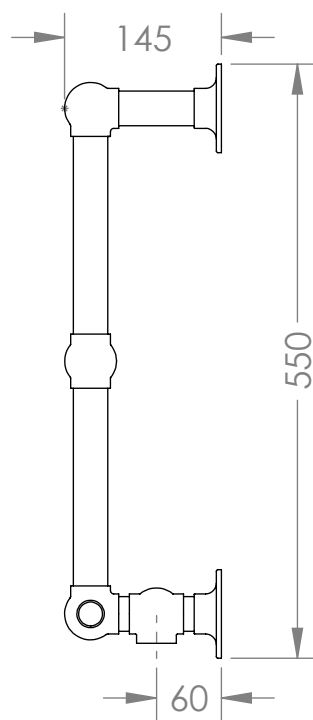
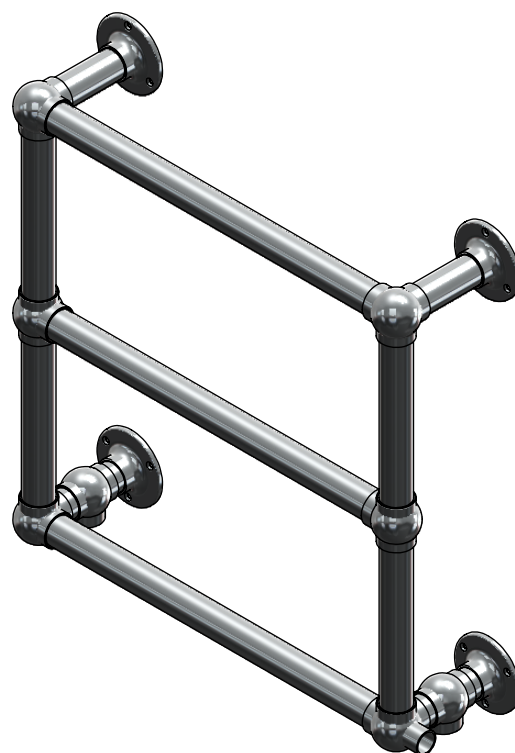
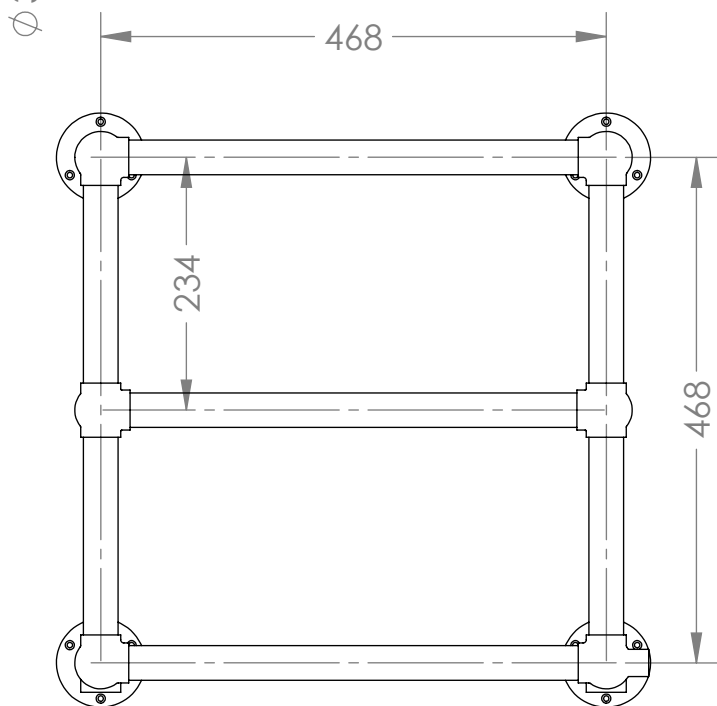

HD Heating strongly recommend that pipework isn't installed (or existing pipework modified) until the towel warmer is installed in its final location.

Finishes Available:

Polished Brass, Chrome, Nickel, Satin Nickel, Bronze Shades, Gold. Please provide sample of any others for us to match

SCALE: 1:7 APPROX WEIGHT 4.56KG

Units 2 & 2A Stamford Street
Amblecote, Stourbridge,
Worcestershire
England, DY8 4HR

THE STERLINGHAM CO. LTD.

For Dual Fuel Towel Warmers:

Tappings For Hydronic & Dual Fuel: 1/2" BSP
Valves & Element Must Be Purchased In Addition To This Towel Warmer
Checks Should Be Made With Your Local Water Authority To Ensure That The
Water Quality Will Not Cause Dezincification Of The Brass Material.

MANUFACTURED FROM BRASS TUBE

Telephone : 01384 370901
Fax : 01384 880159
sales@sterlingham.co.uk
www.sterlingham.co.uk